

SOLDER SUFFIX	CUSTOMER TERMINAL	RoHS	LEAD(Pb)-FREE
LF1	Sn96%, Ag4%	Yes	Yes

TERM. NO.'s FOR REF. ONLY  
CUSTOMER TERM. NO.'s IN ( )

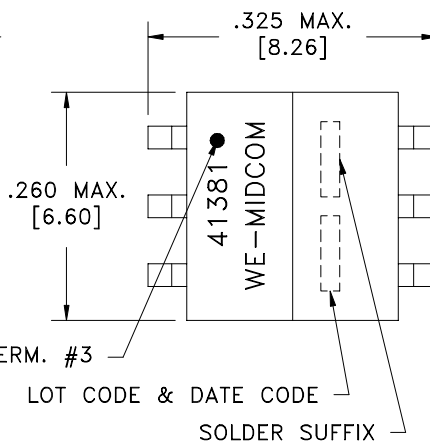
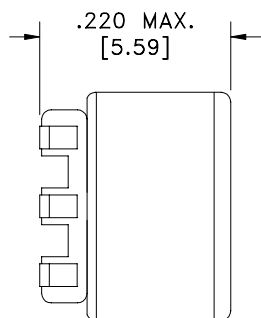
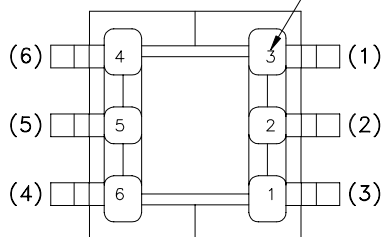

DOT LOCATES TERM. #3

LOT CODE & DATE CODE

SOLDER SUFFIX

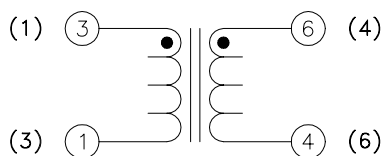

AREA REPRESENTS  
TERMINAL PAD DIMENSIONS

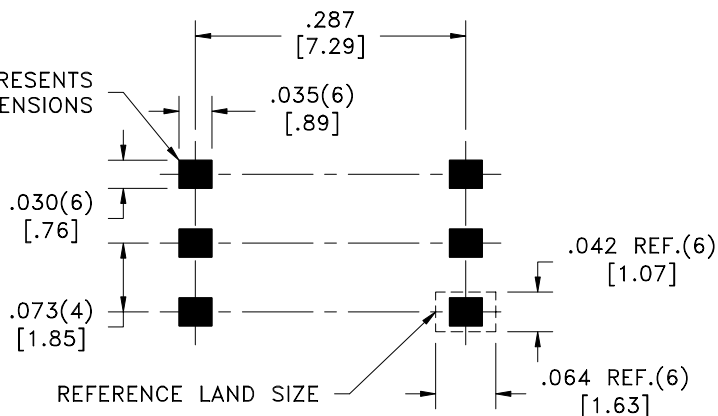

REFERENCE LAND SIZE

CUSTOMER TO DETERMINE LAND LAYOUT

**ELECTRICAL SPECIFICATIONS @ 25°C unless otherwise noted:**

D.C. RESISTANCE (@20°C): 3-1, 1.95 ohms ±15%.  
6-4, 2.30 ohms ±15%.

DIELECTRIC RATING: 500VAC, 1 minute tested by applying 625VAC for 1 second between 3-6.

INDUCTANCE: 90uH ±5%, 10kHz, 100mVAC, 3-1, Ls.

TURNS RATIO: (3-1):(6-4) = 1:1, ±1%.

OPERATING TEMPERATURE RANGE: -40°C to +85°C.

DETAILS SUBJECT TO CHANGE

**Midcom, Inc.**

Watertown, SD USA  
Toll Free: 800-643-2661  
Fax: 605-886-4486

Unless otherwise specified:  
Tolerances: Fractions: ±1/64  
Angles: ±1° Decimals: ±.005 [.13]

DRAWING TITLE

**INDUCTOR**

REVISIONS: SEE SHEET 1

Midcom

DRAWING NO.

**41381R-LF1**

SCALE ---

REV.

6A  
3/07

SHEET 2 OF 5

DWG # 41381R-LF1

This drawing is dual dimensioned.  
Dimensions in brackets are in millimeters.